



POLE ADAPTOR  
SUPPLIED  
FOR EXTENDED  
CEILING DROPS

# BT899XL

## EXTRA-LARGE PROJECTOR CEILING MOUNT WITH MICRO-ADJUSTMENT



BT899XL is a universal projector ceiling mount designed to mount projectors up to 25kg. Compatible with B-Tech's System 2 professional range, this mount can be fitted flush to the ceiling or attached to BT7850 Ø50mm poles using the supplied pole adaptor. The Projector Mount is designed with easy adjustment of tilt, roll and swivel and optional micro-adjustment for short throw projectors making this mount the ideal solution for installing heavy duty projectors.

### SPECIFICATION

|                              |         |
|------------------------------|---------|
| Max load                     | 25kg    |
| Tilt (pitch)                 | +/- 13° |
| Roll                         | +/- 6°  |
| Yaw                          | 360°    |
| Ceiling drop                 | 98.5mm  |
| Max distance between fixings | 493mm   |

### FEATURES

- Can be mounted directly to the ceiling or onto a pole
- Compatible with the B-Tech System 2 Professional Range and 1.5" NPT pipe systems
- Pre-assembled for simple three step installation
- Micro-adjustment for short throw projectors
- Integrated cable management for a smart installation
- Security locking screws and Allen key provided for a secure installation
- Unique 'Carousel' mounting plate for universal compatibility
- Suitable for projectors using M2.5, M3, M4, M5 and M6 fixings
- All mounting hardware included



Unique 'carousel' mounting plate for universal compatibility



Features easy tilt, roll and swivel functions



Compatible with B-Tech System 2 poles and ceiling mounts



Micro-adjustment feature is ideal for short throw projectors

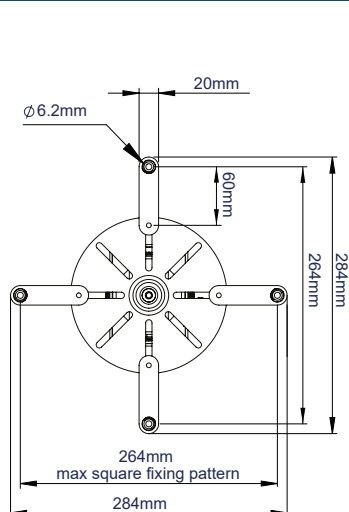

**TOP VIEW / CEILING PLATE**  
WITH OPTIONAL SMALL  
EXTENSION LEGS

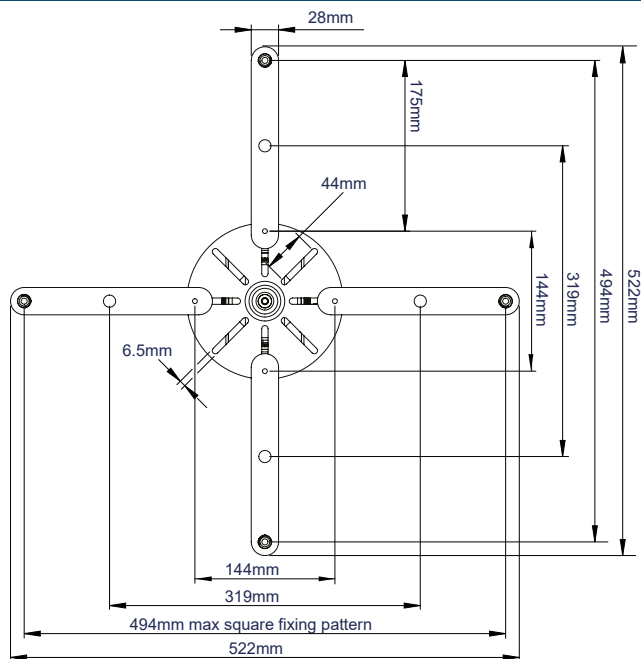

TOP VIEW / CEILING PLATE  
WITH OPTIONAL LARGE EXTENSION LEGS

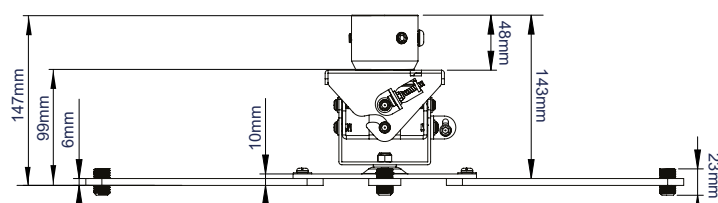

**SIDE VIEW / FLAT WITH POLE ADAPTOR ATTACHED**

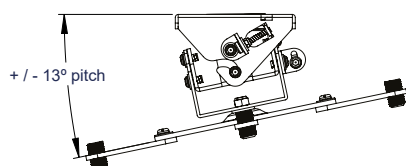

### SIDE VIEW / PITCH

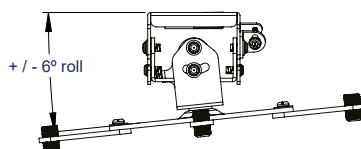

FRONT VIEW / ROLL

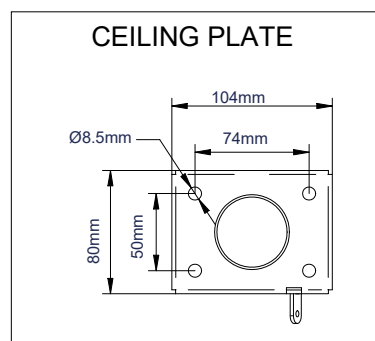

## PACKING INFORMATION

| COLOUR: | ORDER REF: | EAN CODE:     | MASTER CARTON QTY: | INNER CARTON QTY: | MASTER CARTON WEIGHT: | MASTER CARTON CUBE: |
|---------|------------|---------------|--------------------|-------------------|-----------------------|---------------------|
| Black   | BT899XL/B  | 5019318089657 | 8                  | 0                 | 11.7kg                | 0.022cbm            |

**ORIGINAL DESIGNS BY B-TECH AV MOUNTS - REGISTERED DESIGNS & PATENTS APPLY**

## RELATED PRODUCTS



**Ø50mm Poles** available in different lengths up to 3m



**Ceiling Mount** securely fixes Ø50mm poles to the ceiling



**Ceiling Mount with Tilt** ideal for mounting Ø50mm poles to angled ceilings



**Projector Ceiling Mount with Micro-Adjustment** Maximum distance between fixings 370mm